

Connecting Link Grade 8

POWERTEX



Standard: EN 1677-1

Features: Chain Connecting Link European Manufactured, Long service life.

Material: Grade 80 Alloy Steel

Marking: According to standard, Manufacturer's symbol and Grade

Finish: Powder Coated

Standard: EN 1677-1

Safety factor: 4:1

Grade: 8

Select a row from the table below, then click the add to quote button

Part Code	Code	WLL t ton	Chain (mm)	A mm	C mm	O mm	R (mm)	P mm	S (mm)	Weight kg
--	V 06.8 U	1.12	6	14.1	18	18	44.4	7.8	7.6	0.06
07E0100	V 07.8 U	1.5	7	16.3	20	20	51	10	9	0.12
--	V 08.8 U	2	8	18.35	25	23	61.5	11.5	10	0.18
07E0110	V 10.8 U	3.15	10	23	30	27	72	12.6	12.6	0.33
07E0120	V 13.8 U	5.3	13	27.6	36	34	88	19	16.7	0.7
07E0130	V 16.8 U	8	16	33	40	39	103	21	21	1.14
--	V 20.8	12.5	18+20	41.7	48	47	115	29.5	24.5	2.1
--	V 22.8	15	22	49	51	55	133	26.5	26.5	2.2
--	V 26.8	21.2	26	61	68	67	164	32	30	5.1
--	V 32.8 U	31.5	32	80	80	86	194	40	32	8.5

1

Add to quote

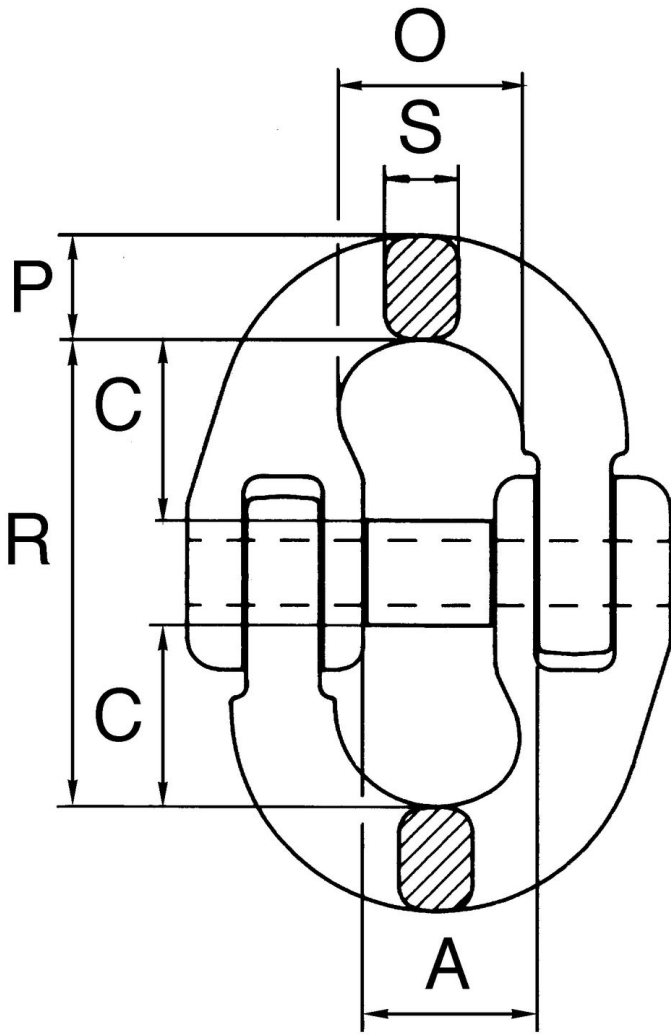

Unit C1, Harworth Industrial Estate
Bryans Close
Harworth
Doncaster
DN11 8RY

01302 756 777
info@certex.co.uk