

# POWERTEX Dee Shackle PDSP

## POWERTEX

**Design:** Dee type shackle supplied with screw pin. According to EN 13889 and meets performance requirements of US Federal Specification RR-C-271 Type IVB Class 2, Grade A.

**Material:** Forged alloy steel, supplied with alloy bolt.

**Marking:** According to standard, WLL, CE, size, grade, batch number and manufacturer ID.

**Finish:** All parts hot dip galvanized + screw pin additional powder painted.

**Standard:** EN 13889

**Note:** Not to be heat treated.

**Safety factor:** 6:1.

**Grade:** 6



Select a row from the table below, then click the add to quote button

Part Code	Code	WLL ton	Nominal size In.	Pin Ø d1 (mm)	a* mm	c* mm	d mm	d2 (mm)	H1 mm	Weight kg
--	1301	0.33	3/16	6,3	10	21,85	5	14,5	29	0.025
05A4470	1302	0.5	1/4	8	13	22	6,5	17,5	38	0.042
05A4480	1303	0.75	5/16	9,5	13,5	25,5	8	21	42,5	0.068
05A4490	1304	1	3/8	11,2	17	30,9	10	25	51,5	0.13
05A4500	1305	1.5	7/16	12,7	18,5	36,4	11	27	58	0.185
05A4510	1306	2	1/2	15,8	20,6	41,4	12,7	30,5	67	0.29
05A4520	1307	3.25	5/8	19	27	51	16	40	85	0.58
05A4530	1308	4.75	3/4	22	32	63	19	48	98,5	0.93
05A4540	1309	6.5	7/8	25	37	72	22	54	114	1.45
05A4550	1310	8.5	1	28	43,5	81,75	26,5	60	129,5	2.06
05A4560	1311	9.5	1-1/8	32	48	94	29	68	144	2.91
05A4570	1312	12	1-1/4	35	53	102	32	76	157	4.15
05A4575	1313	13.5	1-3/8	38	59	113,5	35	84	171	5.5
05A4580	1314	17	1-1/2	42	62	123	38	92	186	6.97
05A4585	1315	25	1-3/4	50	75	148	45	106	227	11.22
05A4590	1316	35	2	55	84	174,5	52	122	253	16.36
05A4595	1317	55	2-1/2	70	107	205,5	66	145	318	31

\*Tolerance: +/- 5%

1

Add to quote

Download

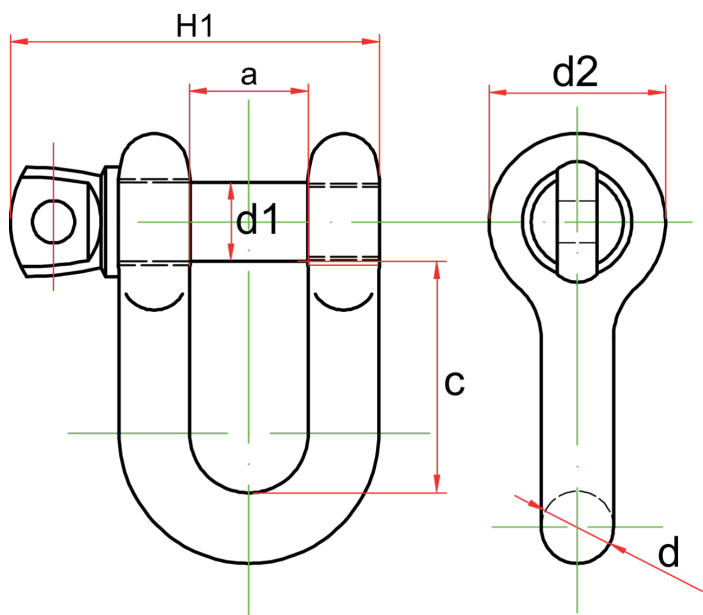

Unit C1, Harworth Industrial Estate  
Bryans Close  
Harworth  
Doncaster  
DN11 8RY

[01302 756 777](tel:01302756777)  
[info@certex.co.uk](mailto:info@certex.co.uk)