

Anchorage Point PSA-YEP

General: Rotates through 360° adjustable in the direction of the load.
 Load rated parts are 100% magnaflux crack detected.
 Individual forged parts and cap screw are traceable to Test Certification.
 Passed 22.2 KN/person Load testing.
 Passed 150 kg dynamic fall testing (EU standard is 100 kg).
 Meets all requirements of the German BG BAU (Employer's insurance association of the building industry).
 Correspond to the European Directive for "personnel protection equipment" (89/686/EWG).
 PSA - Lifting point to be as an anchor point for personal protective equipment.

Max number of persons: 1-2

Material: Manufactured from forged alloy steel, quenched and tempered
Finish: Yellow painted

Safety factor: 4:1



Select a row from the table below, then click the add to quote button

Part Code	Torque Nm	Max. number of persons	thread M	H mm	B mm	C mm	D mm	E mm	F mm	S mm	W mm	Weight kg
--	10	1 person	M12 x 1.75	45	30	10	11	19	33	8	52	0.2
--	30	2 person	M16 x 2	52	35	14	13	24	35	10	61	0.3
--	70	2 person	M20 x 2.5	60	40	16	15	30	44	12	70	0.6

1

Add to quote

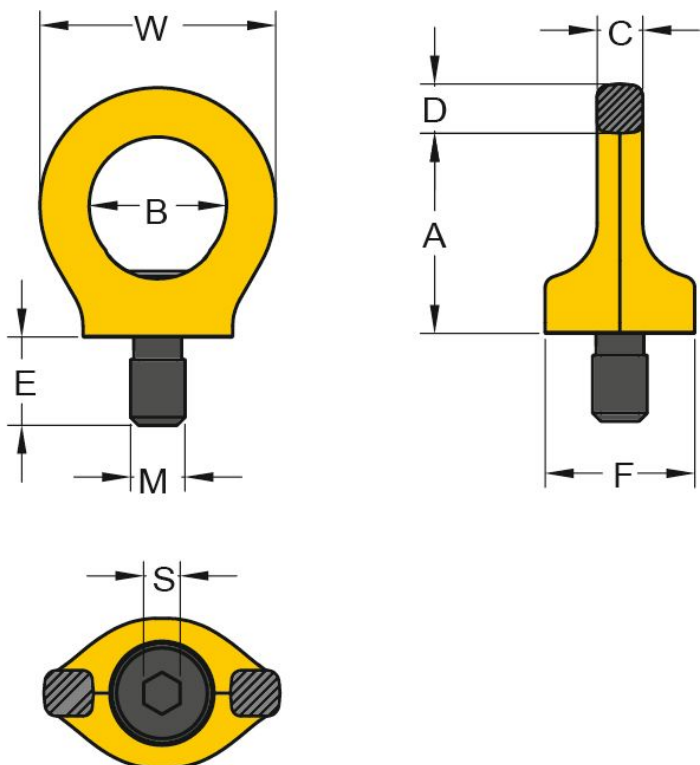

Unit C1, Harworth Industrial Estate
Bryans Close
Harworth
Doncaster
DN11 8RY

01302 756 777
info@certex.co.uk