

Anchorage Point PSA-YEP



- Rotates through 360° adjustable in the direction of the load.
- Load rated parts are 100% magnaflux crack detected.
- Individual forged parts and cap screw are traceable to Test Certification.
- Passed 150 kg dynamic fall testing (EU standard is 100 kg).
- Meets all requirements of the German BG BAU (Employer: s insurance association of the building industry).
- Correspond to the European Directive for “personnel protection equipment” (89/686/EWG).
- PSA - Lifting point to be as an anchor point for personal protective equipment.



Features: Built-in RFID/NFC chip

Material: Manufactured from forged alloy steel, quenched and tempered

Marking: According to standard

Finish: Yellow painted

Standard: EN 795, EN 365, EN 50308

Select a row from the table below, then click the add to quote button

Part Code	Max. number of persons	Torque Nm	Max. number of persons	thread M	H mm	B mm	C mm	D mm	E mm	F mm	S mm	W mm	Weight kg
--	1	10	1 person	M12 x 1.75	45	30	10	11	19	33	8	52	0,2
--	2	30	2 person	M16 x 2	52	35	14	13	24	35	10	61	0,3
--	2	70	2 person	M20 x 2.5	60	40	16	15	30	44	12	70	0,6

1

Add to quote

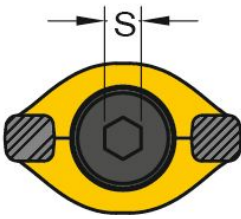
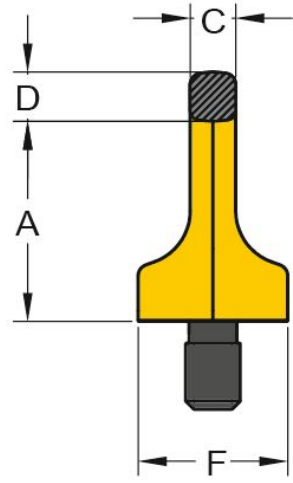
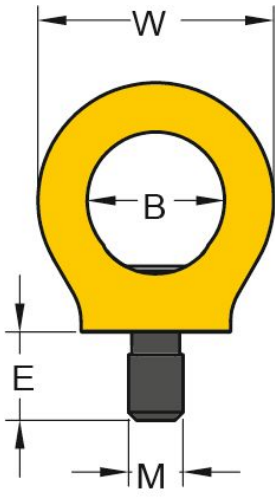

Unit C1, Harworth Industrial Estate
Bryans Close
Harworth
Doncaster
DN11 8RY

[01302 756 777](tel:01302756777)
info@certex.co.uk