

## Eye Hook Crosby L-320 CN

# Crosby

### Features:

- Proper design, careful forging and precision controlled quenched and tempering give maximum strength without excessive weight and bulk.
- Hook extra marked with Deformation Indicators – Two strategically placed marks, one below just the shank or eye and the other on the hook tip, which allows for a QUIC-CHECK™ measurement to determine if the throat opening has changed, thus indicating abuse or overload. To check, use a measuring device to measure the distance between the marks. If the measurement does not meet the dimensions shown below (Deformation Indicator AA), the hook should be inspected further for possible damage.
- Hook extra marked with Angle Indicators – Indicates the maximum included angle which is allowed between two (2) sling legs in the hook.
- Also Available in Alloy steel Grade 8.

**Material:** Carbon steel

**Marking:** According to standard, CE-marked

**Standard:** EN 1677-5

**Safety factor:** 5:1

**Grade:** 4

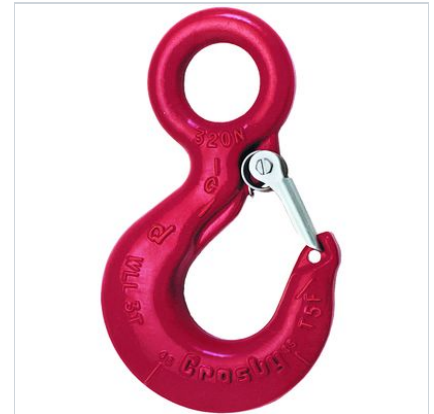

Select a row from the table below, then click the add to quote button

Part Code	WLL ton	Deformation Indicator AA	C mm	D mm	F mm	G mm	J mm	K mm	M mm	N mm	O mm	Q mm	T mm
04F0090	0.75	38.1	85	72	31.8	18.5	22.9	16	16	9.14	22.6	19.1	22.1
--	1	50.8	97	79	35.1	21.3	23.6	18	18	10.7	23.1	23.1	24.9
04F0100	1.6	50.8	105	89.5	38.1	25.4	25.4	22.4	22.4	14	25.4	28.7	26.2
--	2	50.8	119	101	41.4	28.7	28.7	23.9	23.8	14.7	27.7	31.8	29.5
04F0110	3	63.5	147	122	51	36.6	37.3	33.3	33.3	18.3	34.5	39.6	38.9
--	5	76.2	187	159	63.5	46	44.5	42.2	42.2	22.9	40.9	51	49.8
--	7.5	102	230	189	76	57	58	47.8	41.4	28.2	53	62	62.5
--	10	102	256	211	82.5	66	63.5	55.5	49.3	32.3	57.5	72	66.5
--	15	127	318	262	108	76	84	68.5	60.5	39.6	76.5	89	72
--	20	165	357	346	127	92	102	76	76.2	44.5	82.5	89	87.5
--	25	178	462	357	137	116	108	95.2	81	55.4	86	125	121
--	30	203	511	392	152	129	121	114	82.6	55.4	86	125	121
--	40	254	602	470	178	152	146	140	99.3	64.3	105	145	145

\*NOTE: Proof load is 2 times Working Load Limit.

1

Add to quote

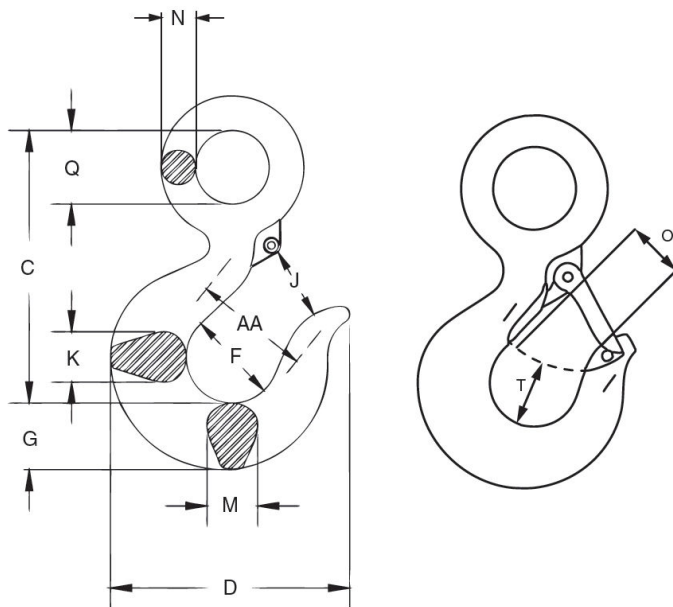

Unit C1, Harworth Industrial Estate  
 Bryans Close  
 Harworth  
 Doncaster  
 DN11 8RY

01302 756 777  
[info@certex.co.uk](mailto:info@certex.co.uk)