

## Crosby Swivel S3 - Jaw / Eye



**Design:** Jaw and eye swivel with tapered roller thrust bearing. Suitable for frequent rotation under load.

**Proof load:** 2 x WLL.

**Marking:** WLL.

**Finish:** Painted.

**Note:** Crosby swivels should only be used with the recommended wire rope.

**Safety factor:** 5:1.



Select a row from the table below, then click the add to quote button

Part Code	WLL ton	Rope Ø (mm)	Swivel No	C mm	G mm	H mm	J mm	K mm	N mm	O mm	Q mm	R mm	S mm	T mm	Weight kg
--	3	13	3-S-3	237	70,0	19,1	22,4	41,1	33,3	25,4	19,1	26,2	28,4	31,8	4.14
--	5	16	5-S-3	256	76,0	22,4	25,4	57,0	41,1	28,4	25,4	32,5	31,8	31,8	6.12
--	8.5	19	8-S-3	311	102	25,4	39,5	71,5	54,0	35,1	31,8	35,8	41,1	38,1	11.3
--	10	22	10-S-3	409	114	38,1	44,5	86,1	89,0	44,5	42,9	42,9	70,0	47,8	19.7
--	15	26	15-S-3	425	127	38,1	44,5	86,0	89,0	44,5	49,3	51,5	70,0	54,0	27.7
--	25		25-S-3	546	152	51,0	51,0	117	93,5	60,5	57,0	58,5	98,5	60,5	61
--	35		35-S-3	546	165	51,0	51,0	117	93,5	60,5	57,0	58,5	98,5	60,5	68
--	45		45-S-3	657	178	57,0	63,5	127	102	76,0	63,5	64,5	102	76,0	102

1

Add to quote

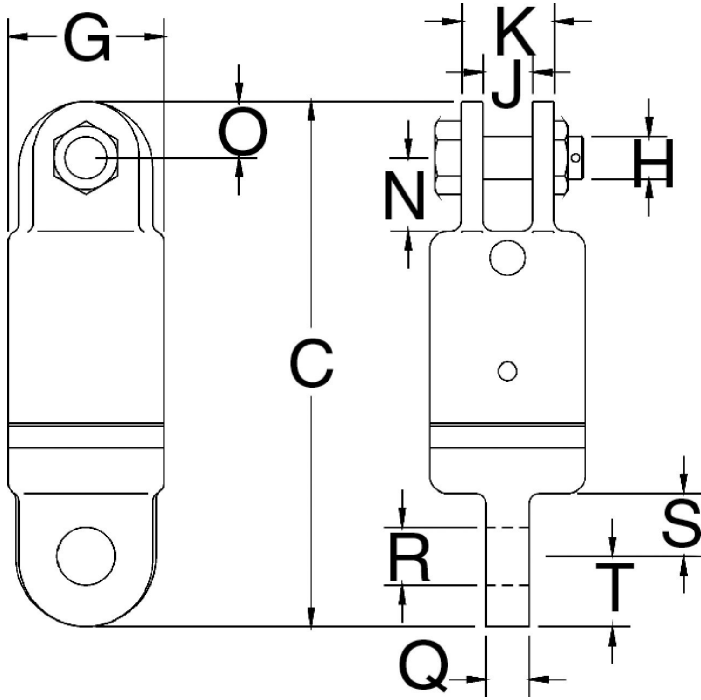

Unit C1, Harworth Industrial Estate  
Bryans Close  
Harworth  
Doncaster  
DN11 8RY

01302 756 777  
[info@certex.co.uk](mailto:info@certex.co.uk)