

Standard Steel Sleeves Crosby COLD TUFF® S-505

Product information



- For flemish eye wire rope splicing.
- Designed for low temperature toughness.
- Resists cracking when swaged (equals or exceeds stainless steel sleeves).
- Special processed low carbon steel.
- COLD TUFF® for better swageability.
- Can be stamped for identification after swaging without concern for fractures when following these directions.
 - Use round corner stamps to a maximum depth of 1.38mm.
 - The area for stamping should be on the side of the sleeve in the plane of the sling eye, and no less than 7mm from either end of the sleeve.
- Standard Steel Sleeve terminations have efficiency ratings as follows based on the catalog strength of wire rope.

... [Read more](#)

Standard Steel Sleeves Crosby COLD TUFF® S-505

Blueprint

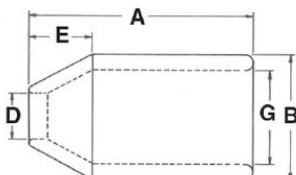

Technical data

Part code	Rope Ø range mm	Ferrule size mm	A mm	B mm	D, mm	E mm	G, mm	Weight kg/100pc
120100700220	6-7	7	25.4	16.8	7.88	7.12	11.9	3.6
120100800220	8	8	38.1	23.1	11.2	11.2	15.8	4.08
120101000220	9-10	10	38.1	23.1	11.9	9.91	16.8	5.44
120101100220	11	11	51	31	14	16.5	21.6	13.6
120101300220	13	13	51	31	16	14.2	23.1	13.2
120101400220	14	14	70	37.3	17.5	16	26.2	30.8
120101600220	16	16	70	37.3	19.1	16	27.7	25.9
120101900220	18-19	19	81	43.7	23.1	21.3	32.5	40
120102200220	22	22	90.5	51.5	26.2	25.4	38.9	62
120102600220	25-26	26	102	58	29.5	28.6	43.7	89
120102900220	28-29	29	122	63.5	32.5	31.8	49.3	118
120103200220	31-32	32	132	70.5	36.5	35.8	55	154
120103500220	34-35	35	148	76	39.7	39.7	60.5	195
120103800220	37-38	38	159	82.5	42.9	42.9	67	226
120104500220	44-45	45	184	97.5	49.2	50	79.5	367
120105200220	50-52	52	216	111	57	57	92	510

Standard Steel Sleeves Crosby COLD TUFF® S-505

S-505 Termination Efficiency

Size (mm)	Type of Wire Rope	
	IWRC	FC
6 - 26	96%	93%
28 - 52	92%	89%
56 and larger	90%	87%