

Bolt Type Chain Shackle Crosby G-2150

Product information



Design: Bolt Type Chain shackle. Thin hex head bolt/nut with cotter pin.

Meets the performance requirements of Federal Specification RR-C-271H, Type IVB, Grade A, Class 3, except for those provisions required of the contractor

... [Read more](#)

Material: Forged — Quenched and Tempered, with alloy pins.

Marking: According to standard, CE-marked

Finish: Hot Dip galvanized or self colored.

Standard: EN 13889, US. FED. SPEC. RR-C-271, ASME B30.26

Safety factor: 6:1

Grade: 6

Bolt Type Chain Shackle Crosby G-2150

Blueprint

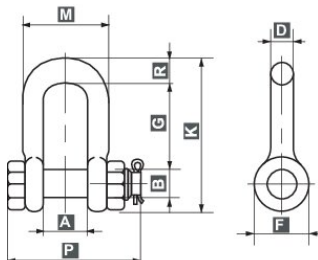

Technical data

Part code	WLL ton	A mm	B mm	D, mm	F mm	G, mm	K mm	Mmm mm	Pmm mm	Rmm mm	A Tolerance +/- mm	G Tolerance +/- mm	Weight kg
420100050040	0.5	11.9	7.9	6.4	15.5	19.1	40.4	24.6	39.6	6.35	1.5	1.5	0.06
420100750040	0.75	13.5	9.7	7.9	19.1	25.4	48.5	29.5	46.2	7.85	1.5	1.5	0.1
420100100040	1	16.8	11.2	9.7	23.1	31	58.5	35.8	55	9.65	1.5	3.3	0.15
420100150040	1.5	19.1	12.7	11.2	26.9	36.1	67.5	41.4	63.5	11.2	1.5	3.3	0.22
420100200040	2	20.6	16	12.7	30.2	41.4	77	46	71	12.7	1.5	3.3	0.34
420100330040	3.25	26.9	19.1	16	38.1	51	95.5	58.5	89.5	16	1.5	3.3	0.67
420100480040	4.75	31.8	22.4	19.1	46	60.5	115	70	103	20.6	1.5	6.35	1.14
420100650040	6.5	36.6	25.4	22.4	53	71.5	135	81	120	24.6	1.5	6.35	1.75
420100850040	8.5	42.9	28.7	25.4	60.5	81	151	93.5	135	25.4	1.5	6.35	2.52
420100950040	9.5	46	31.8	28.7	68.5	91	172	103	150	31.8	1.5	6.35	3.45
420101200040	12	51.5	35.1	31.8	76	100	191	115	165	35.1	1.5	6.35	4.9
420101350040	13.5	57	38.1	35.1	84	111	210	127	183	38.1	3.3	6.35	6.24
420101700040	17	60.5	41.4	38.1	92	122	230	137	196	41.1	3.3	6.35	7.72
420102500040	25	73	51	44.5	106	146	279	162	230	54	3.3	6.35	14.2
420103500040	35	82.5	57	51	122	172	312	184	264	60	3.3	6.35	21.2
420105500040	55	105	70	66.5	145	203	377	238	344	66.5	6.35	6.35	38.6
420108500040	85	127	82.5	76	165	216	429	279	419	89	6.35	6.35	56.4