

## Swivel Jaw / Hook Crosby S1

---

### Product information



**Design:** Swivel with jaw and hook equipped with tapered roller thrust bearing.

**Features:**

- Suitable for frequent rotation under load.
- All swivels individually Proof Tested to 2 times the Working Load Limit.
- Pressure lube fitting provided
- All hooks furnished with latches
- All jaws complete with bolts, nuts and cotter pins.
- Other types and capacities up to 1250t available on demand.

... [Read more](#)

---

**Marking:** CE-marked

**Note:** Always check before use if your steel wire rope is suitable for use with a swivel.

**Warning:** Not to be used on demolition- (wrecking-) balls!

**Safety factor:** 5:1

## Swivel Jaw / Hook Crosby S1

### Blueprint

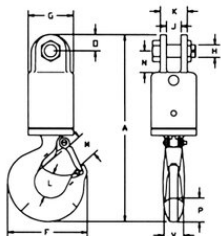

### Technical data

Part code	Rope Ø range mm	WLL ton	Swivel No	A mm	F mm	G mm	H mm	J mm	K mm	L mm	M mm	N mm	O mm	P mm	V mm	Weight kg
422500300280	13	3	3-S-1	291	123	70	19.1	22.4	41.1	38.9	35.8	33.3	25.4	36.6	28.4	4.45
422500500280	16	5	5-S-1	339	160	76	22.4	25.4	57	49.3	42.9	41.1	28.4	46	36.6	7.04
422500850280	19	8.5	8-S-1	418	192	102	25.4	39.5	71.5	62.5	56.5	54	35.1	57	41.1	13.3
422501000280	22	10	10-S-1	502	212	114	38.1	44.5	86	66	61	89	44.5	66	49.3	21.2
422501500280	26	15	15-S-1	565	263	127	38.1	44.5	86	71.5	81	89	44.5	76	60.5	33.5
422502500280		25	25-S-1	680	346	152	51	51	117	87.5	92	93.5	60.5	93	76	64
422503500280		35	35-S-1	760	357	165	51	51	117	98.5	95.5	93.5	60.5	116	81	100
422504500280		45	45-S-1	891	392	178	57	63.5	127	121	108	102	76	129	82.5	114