

Vertical Plate Clamps 92 Series

Product information



These clamps are primarily used for transporting sheet metal and steel plates in the vertical position, as well as lifting and rotating through 180°. They can also be used for transporting steel constructions and profiles. It is recommended to use a pair of plate clamps in conjunction with a spreader beam for long plate. Product function The jaw is opened and closed with the locking lever, except for the 92-500 which uses a positive spring-loaded cam. The safety lock spring loads the cam jaw, preventing the clamp from opening even when there is no load on the jaw. Workmanship & Parts These plate clamps are service-friendly, making it easy to exchange parts, which are readily available. Clamp repairs are available through the factory, or can be done by a competent person.

... [Read more](#)

Note: Surface of the material being clamped must have a hardness level below HRC 30/Brinell 300.

Warning: Min . WLL is 10% of max . WLL

Vertical Plate Clamps 92 Series

Blueprint

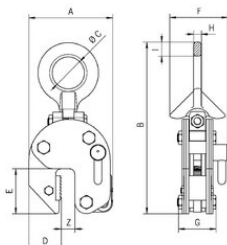

Technical data

Part code	WLL ton	Jaw width mm	A mm	B mm	C mm	D mm	E mm	F mm	G mm	H mm	I mm	Weight kg
502100050162770	0.5	0-16	99	195	29	33	47	50	48	11	15	1.5
502100150202770	1.5	0-20	126	225	50	49	70	82	55	13	20	3
502100200322770	2	0-32	192	312	80	75	96	100	81	20	24	8
502100300322770	3	0-32	192	320	80	75	96	100	81	30	30	12